

Fish Finder & GNSS Plotter Combo

Model: XF-1069GF



Features

- ▶ 10.4" Color LCD with 800 X 600 resolution and wide angle of view.
- ▶ GPS and Beidou GNSS both support to provide more accurate positional information.
- ▶ Provide AIS input interfaces to connect with AIS device conveniently and display AIS targets dynamically on the chart.
- ▶ Echo Sounder transmit power is 600W and transmit frequency is 50KHz / 200KHz.
- ▶ Intelligent automatic operation mode in Echo Souder mode, such as automatic seabed tracking, auto range, auto shift, auto gain control.
- ▶ Pre build-in global reference chart which can be upgraded regularly.
- ▶ Floating GND power design, more stable and reliable.
- ▶ Conform to IP65 water-proof standard.



Installation Dimension

[Unit: mm]

Display Unit		XF-1069GF	
Display Type		Color TFT LCD	
Size		10.4 inch	
Resolution		800 × 600 pixels	
Brightness		300cd/m²	
Interface		2 Ports NMEA0183 Output, 2 Ports NMEA0183 Input	
Chart		Internal Chart & C-MAP(MAX)	
Power Supply		DC 12V~36V	
WiFi		802.11 b/g/n	
Power Consumption		14W or less (24 VDC)	
GNSS			
GNSS Receiver		72 channels	
Receive Frequency		GPS L1: 1575.42MHz; BDS B1: 1561.098MHz	
Accuracy	GPS&BDS	2.5m (CEP50% open sky)	
	GPS	5m (CEP50% open sky)	
	BDS	5m (CEP50% open sky)	
Speed Accuracy		0.1m/s (50%@10m/s)	
Time to First Fix		Cold Start <30s , Hot Start <1s	
Fish Finder			
Transmit Frequency		50/200KHz	
Transmit Power		600W	
Depth Units		m/fm/ft	
Range Scope		The unit is m/fa: 2.5, 5.0, 10, 15, 20, 30, 40, 50, 80, 100, 150, 200, 300, 500 The unit is ft: 5, 10, 20, 30, 40, 60, 80, 100, 150, 200, 300, 500, 1000, 2000	
Display Modes		Single Frequency, Dual Frequency, Single Frequency/ Bottom Signal Frequency/Zoom in sea bed, Signal Frequency/B.D.	
A-Scope		User can switch on/off the A scope	
Gain Control		The adjustment range of each operating frequency is 31 levels	
STC Level		The adjustment range of each operating frequency is 10 levels	
Echo Color		Available in monochrome, 8 colors, 16 colors	
Echo Single Level		1, 2, 3, 4	
Echo Background		Blue, Black, White	
Decoloration		Provide 4 weaker echo colors and can be closed	
Seabed Contour		Highlight the display of the bottom of the seabed	
Image Speed		0 1 2 3 4 5 6 7 8	
Noise Reduction		Low, medium and high	
Depth Alarm		Depth-water, Low-water	
Fish Alarm Color		1L(Weak) 2L 3L 4L(Medium) 5L 6L 7L(Strong)	
Alarm Size of Fish		Small, Medium, Large	
Depth Reading		Depth line position adjustment is flexible, and can be read in real time	
Water Depth Correction		1500 m/s, Adjustable range, 1400-1600m/s	
Waterline Correction		Adjustable 0.1 unit at a time, adjustable range, 0.0-19.9	
The Output Statement of Water Depth		\$XXDPT (NMEA 0183)	
Enviromental			
Working Temperature		-15°C~+55°C	
Storage Temperature		-20°C~+60°C	
Waterproof		IP65	

Packing List

Name	Quantity	Name	Quantity
Display	1	Screw of ST4.2*20	4
Transducer (Optional)	1	Knob(M8)	2
Power Cable (2m)	1	Larger rubber gasket	4
Data Cable (1.2m)	1	GP80-8M	1
Screw of ST3*20	4	Quick Reference	1

System Connection Diagram and Serial Port Definition

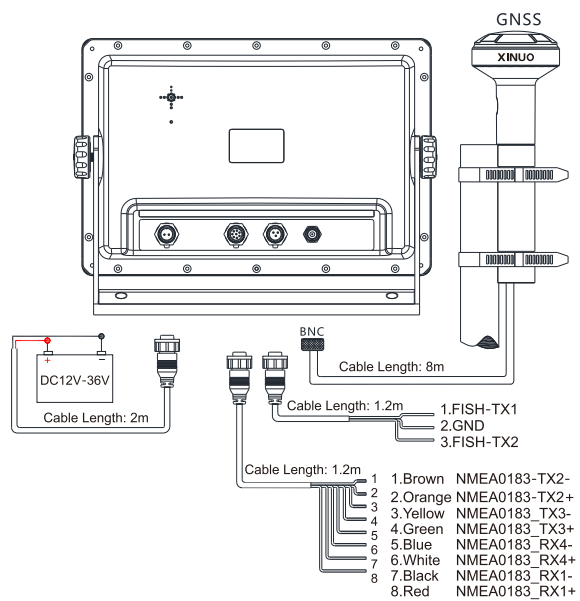

Main Unit Counter Mounting

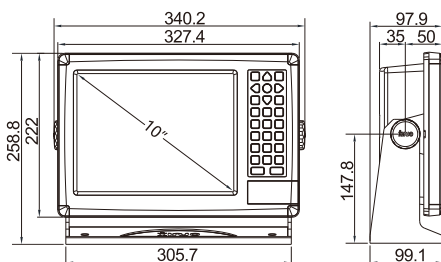

Flush Mounting

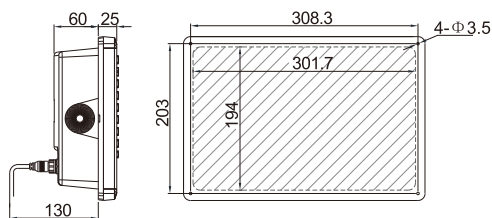

Transducer

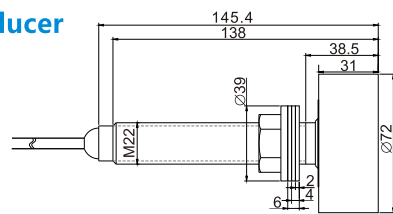

GNSS Antenna Unit (8m)

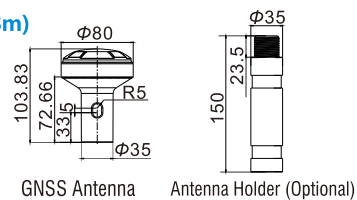

XINUO

Xinuo Information Technology (Xiamen) Corporation Limited

Address: Unit 2001, 1 Chengyi North Street (B04), Software Park III, Xiamen, China

Tel: +86-592-3300300

Fax: +86-592-3300310

Hotline: 400-8868-592

Web: <http://www.xinuo.com>

Email: info@xinuo.com



NEEQ:836189