

Fish Finder & GNSS Plotter Combo

Model: XF-1069GF



Features

- ▶ 10.4" Color LCD with 800 X 600 resolution and wide angle of view.
- ▶ GPS and Beidou GNSS both support to provide more accurate positional information.
- ▶ Provide AIS input interfaces to connect with AIS device conveniently and display AIS targets dynamically on the chart.
- ▶ Echo Sounder transmit power is 600W and transmit frequency is 50KHz / 200KHz.
- ▶ Intelligent automatic operation mode in Echo Souder mode, such as automatic seabed tracking, auto range, auto shift, auto gain control.
- ▶ Pre build-in global reference chart which can be upgraded regularly.
- ▶ Floating GND power design, more stable and reliable.
- ▶ Conform to IP65 water-proof standard.



Installation Dimension

[Unit: mm]

Display Unit		XF-1069GF
Display Type		Color TFT LCD
Size		10.4 inch
Resolution		800 × 600 pixels
Brightness		300cd/m²
Interface		2 Ports NMEA0183 Output, 2 Ports NMEA0183 Input
Chart		Internal Chart & C-MAP(MAX)
Power Supply		DC 12V~36V
WiFi		802.11 b/g/n
Power Consumption		14W or less (24 VDC)
GNSS		
GNSS Receiver		72 channels
Receive Frequency		GPS L1: 1575.42MHz; BDS B1: 1561.098MHz
Accuracy	GPS&BDS	2.5m (CEP50% open sky)
	GPS	5m (CEP50% open sky)
	BDS	5m (CEP50% open sky)
Speed Accuracy		0.1m/s (50%@10m/s)
Time to First Fix		Cold Start <30s , Hot Start <1s
Fish Finder		
Transmit Frequency		50/200KHz
Transmit Power		600W
Depth Units		m/fm/ft
Range Scope		The unit is m/fa: 2.5, 5.0, 10, 15, 20, 30, 40, 50, 80, 100, 150, 200, 300, 500, 1000 The unit is ft: 5, 10, 20, 30, 40, 60, 80, 100, 150, 200, 300, 500, 1000, 2000, 3000
Display Modes		Single Frequency, Dual Frequency, Single Frequency/ Bottom Signal Frequency/Zoom in sea bed, Signal Frequency/B.D.
A-Scope		User can switch on/off the A scope
Gain Control		The adjustment range of each operating frequency is 31 levels
STC Level		The adjustment range of each operating frequency is 10 levels
Echo Color		Available in monochrome, 8 colors, 16 colors
Echo Single Level		1, 2, 3, 4
Echo Background		Blue, Black, White
Decoloration		Provide 4 weaker echo colors and can be closed
Seabed Contour		Highlight the display of the bottom of the seabed
Image Speed		0 1 2 3 4 5 6 7 8
Noise Reduction		Low, medium and high
Depth Alarm		Depth-water, Low-water
Fish Alarm Color		1L(Weak) 2L 3L 4L(Medium) 5L 6L 7L(Strong)
Alarm Size of Fish		Small, Medium, Large
Depth Reading		Depth line position adjustment is flexible, and can be read in real time
Water Depth Correction		1500 m/s, Adjustable range, 1400-1600m/s
Waterline Correction		Adjustable 0.1 unit at a time, adjustable range, 0.0-19.9
The Output Statement of Water Depth		\$XXDPT (NMEA 0183)
Enviromental		
Working Temperature		-15°C~+55°C
Storage Temperature		-20°C~+60°C
Waterproof		IP65

Packing List			
Name	Quantity	Name	Quantity
Display	1	Screw of ST4.2*20	4
Transducer (Optional)	1	Knob(M8)	2
Power Cable (2m)	1	Larger rubber gasket	4
Data Cable (1.2m)	1	GP80-8M	1
Screw of ST3*20	4	Quick Reference	1

System Connection Diagram and Serial Port Definition

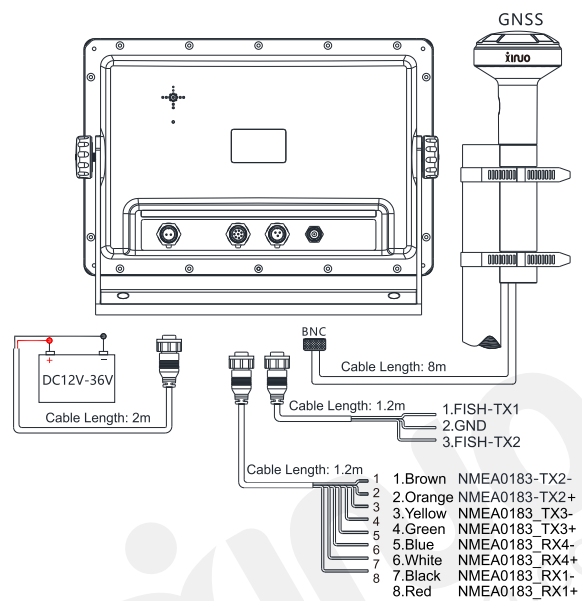

Main Unit Counter Mounting

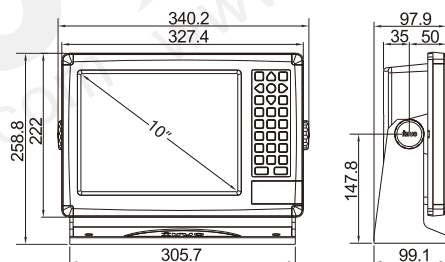

Flush Mounting

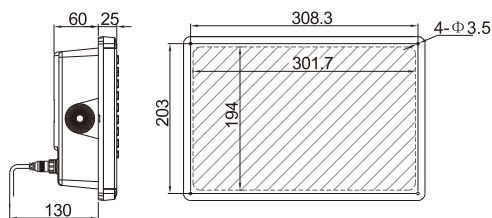

Transducer

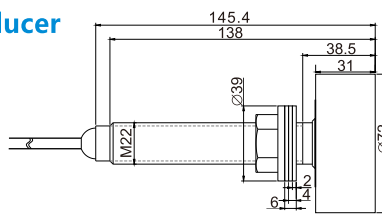

GNSS Antenna Unit (8m)

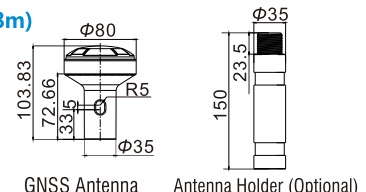

Dealer: